

## Red light FAA L-810 as per FAA (AC 150/5345-43J)



- ICAO low intensity type A B or E with IR and L-810 type with IR
- Light part fully molded with 8 levels of leds
- Redundant circuits for LED's with de-coupled IR
- Surge protection and alarm complying with FAA Engineering Brief 98
- normally open and normally close both available for the alarm
- 2 x ¾" NPT threaded holes for mounting (or with the "NAVILITE-L810-HOLDER" and standard cable entry in absence of FAA rigid conduit)
- no loose part during installation
- Built-in flasher (activated through internal dip-switches with master/slave possibility) to be L-810 (F) and mimic with our L-864 medium intensity P/N 113790RI-240 or our dual color L-865/L-864 medium intensity P/N113725UI, P/N113715U & P/N113758U

Provided with stainless steel bracket and 3 meters of shielded cable 5G1,5

Option IR (visible with Night Vision Goggles as per FAA Advisor 150/5345-43J)

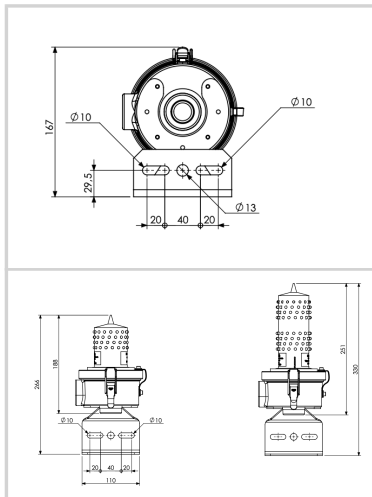

Electrical Characteristics	
Life time	~10years
Main voltage	20-60Vdc
Average wattage	8W (steady mode) or 2W (@ 30 fpm mimic with L-864)
Mechanical Characteristics	
IP degree	IP66
Wiring	Terminal connection (2 power wires and 2 for the alarm)
Operating temperature	-40/+55°C
Weight	1,5 kg
Wire cross section	from 1 to 2,5 mm <sup>2</sup>
Attachment	2 NPT threaded holes
Photometric Characteristics	
IR intensity and wavelength	25mW/sr @ 850nm
Luminous intensity	> 32,5 Cd
Color night time	Red
Vertical beam spread	>10°
Horizontal beam spread	360°
Standards	
Standards compliance	ICAO annex 14 chapter 6, FAA (AC 150/5345-43J), UK MOD, Transport Canada