



PHOTOCELL AC KIT [P/N: 100756-KIT]

Calibrated ambient sensor (photozell) for twilight-night intensity change in accordance with ICAO and FAA for all OBSTA lights or for the change of color and light-intensity



- plug-in modular construction with plated contact surfaces
- possibility to rotate the sensor on its base
- automatic control of the red or dual obstruction lighting according to ambient light in compliance with FAA and ICAO twilight/night triggering level (2 output signals available for night and twilight)
- timer to prevent the functioning of the cell at inopportune times (lightning)

One junction box NAV-JB-8 and the bracket PHOTOCELL-HOLDER are included in this kit

Les dimensions sont en mm
All dimensions are in mm

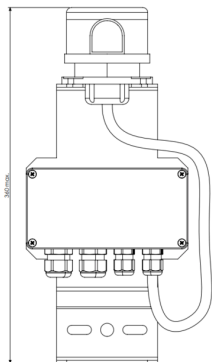
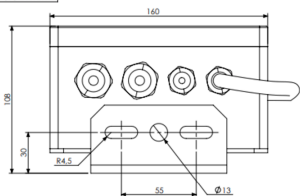

Electrical Characteristics	
Main voltage	110VAC to 240VAC +/-10% 50/60Hz
Average wattage	1.5VA
Max. admissible current	2A contact closed for the night mode and 0,3A for the twilight mode
Mechanical Characteristics	
Cable diameter	Ø11mm
IP degree	IP65 in vertical position
Operating temperature	-35°C/+60°C
Weight	1,3kg
Attachment	vertical bracket
Standards	
Standards compliance	ICAO annex 14 chapter 6, FAA (AC 150/5345-43J), UK MOD, Transport Canada