

110VAC to 240VAC stainless power cabinet for 48Vdc obstafash dual color kits (max 20A)

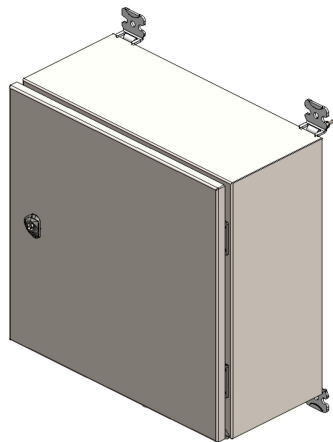

- 'Weather tight' stainless steel 316L power cabinet enclosure
- Test button for day and night
- Alarm dry contact NC and NO
- Master/slave configuration for multiple lights synchronisation
- to be used with photocell 48Vdc
- in option low intensity lights NAVILITE 48Vdc for night only operation,
- wireless gps synchronisation P/N113746

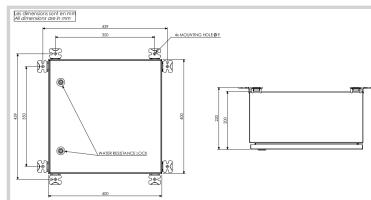

| Electrical Characteristics | |
|----------------------------|---|
| Main voltage | 110VAC to 240VAC +/-10% 50/60Hz |
| Mechanical Characteristics | |
| IP degree | IP65 in vertical position |
| Operating temperature | -20/+45°C |
| Weight | 8 kg |
| Size of the power supply | 590mm (height) x 350mm (width) x 250mm (dept) |
| Wire cross section | from 1 to 4 mm ² |