

Accessories

POWER CABINET WITH BATTERIES

Obstacles require constant beaconing and, consequently, a continual electric power supply.

OBSTA Power Cabinets can be used with all OBSTA obstruction lights 48V and 24VDC except high intensity system.



Application

Power cabinet

The obstacles which require permanent back-up must be fed by a battery cabinet that can supply 12 hours of autonomy in case of power failure. This power cabinet draws its power from the AC main supply and outputs a DC voltage 48V or 24V to feed the lights. The range of units available offers a choice to select the most suitable configuration to match the number of lights and the autonomy required.

Photocells

OBSTA photocells are used to automatically switch the beacons on or off to match changes in the day/night level (day/night switch). Photocell therefore :

- save power (when operating from power cabinet or solar panels)
- increase back-up autonomy.

Description

Power cabinet

The various components in OBSTA power supply cabinets are located in a metal enclosure. The dry batteries used require no servicing during normal operation. An input transformer with thyristors provides a galvanic insulation with DC voltage.

Auxiliary functions are also available (photocell, weatherproof cabinet, etc...).

The cabinet also includes :

- protection against transient overvoltage,
- protection against complete discharge of batteries.

Photocells

OBSTA photocells plug into a socket. A delay system prevents the cell triggering on brief flashes (for example lightning). The actuator is normally open relay.

Main Characteristics

POWER CABINET		Capacity	Power supply	Output voltage	Max DC intensity	Number max. of Obsta STI for 12 hours autonomy
IP20	IP55					
13500	13510	16 Ah	230 V	48V	2,5 A	4 lights STI
13501	13511	25 Ah	230 V	48V	4 A	7 lights STI
13502	13512	40 Ah	230 V	48V	6 A	12 lights STI
13506	13516	7 Ah	230 V	48V	2 A	2 lights STI
13507	13517	3,5 Ah	230 V	48V	2 A	1 light STI
13504	13514	40 Ah	230 V	24V	8 A	1 light MI 24V at 20 flashes/minute
13505	13515	65 Ah	230 V	24V	12 A	1 light MI 24V at 40 flashes/minute

PHOTOCELLS	Power supply	Triggering level
00752	230 V =	50 lux
00755	48 V =	
00754	24 V =	

Power Cabinet

Dimensions in mm

Dimensions (mm)	48VDC					24VDC		Double-casing
Capacity	3,5 Ah	7 Ah	16 Ah	25 Ah	40 Ah	40 Ah	65 Ah	All models
Obsta Part number	13517	13516	13510	13511	13512	13514	13515	---
IP degree	20	20	20	20	20	20	20	55
A	600	600	700	800	800	700	800	1000
B	400	400	500	600	600	500	600	800
C	200	200	250	250	250	250	250	300
D	560	560	660	760	760	660	760	960
E	458	458	558	658	658	558	658	858
Indicators	no	no	yes	yes	yes	yes	yes	Depends on models
Weight (kg)	29,4	33,8	62	84	104,8	75,2	135	Add 38,2 kg

IP degree	20
Operating temperature	0 to 45°C
Power supply	220V +/-10% ; 50 Hz
Attachment	secured by wall brackets (except for the 36AH cabinet) or placed on a flat surface
Connection	by terminal
Maintenance	no
Batteries	lead, gelated type

Specific precautions

- use indoors (except for double-casing cabinet),
- recharge batteries during prolonged storage.

Complementary functions

Output voltage control in manual mode or in automatic mode by crepuscular photoelectric cell.

Other versions

With double-casing for outdoor installation (IP55). See table

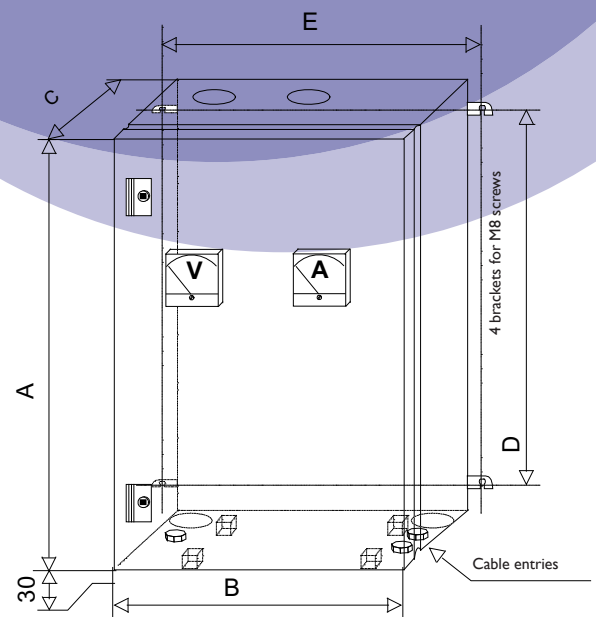

Photocells

Overall dimensions (in mm)

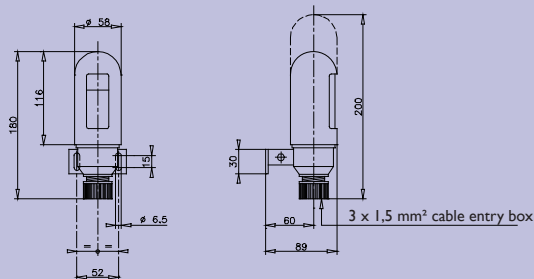

IP degree	67
Operating temperature	-25 to +60°C
Voltage tolerance	-10 ; + 15 %
Consumption	1,5 VA
Weight	300 grs
Attachment	by harness and screws
Connection	screw terminals
Maintenance	none
Complementary functions	10A contact closed in darkness